

# Communications Act base station construction requirements



## Overview

---

(a) Nationwide narrowband PCS licensees shall construct base stations that provide coverage to a composite area of 750,000 square kilometers or serve 37. These rules ensure that entities constructing facilities to support Commission-licensed services take appropriate measures to protect environmental and physical dimensions of such tower or base station. In October 2014, the Federal Communications Commission unanimously consulted with an attorney on legal matters. These documents are meant. Notwithstanding section 704 of the Telecommunications Act of 1996 (Public Law 104-104) or any other provision of law, a State or local government may not deny, and shall approve, any eligible facilities request for a modification of an existing wireless tower or base station that does not. Any request for modification of an existing tower or base station that does not substantially change the physical dimensions of such tower or base station, involving: (i) Collocation of new transmission equipment; (ii) Removal of transmission equipment; or (iii) Replacement of transmission. Nothing in paragraph (1) shall be construed to relieve the Commission from the requirements of the National Historic Preservation Act [1] or the National Environmental Policy Act of 1969. 60001 Wireless Facility Modifications.

## Communications Act base station construction requirements

---



### eCFR :: 47 CFR 1.6100 -

(1) Base station. A structure or equipment at a fixed location that enables Commission-licensed or authorized wireless communications between user equipment and a communications network.

[Get Price](#)

---

### Tower and Antenna Siting

Building a new tower or collocating an antenna on an existing structure requires compliance with the Commission's rules for environmental review. These regulatory processes ensure that appropriate ...



[Get Price](#)

---



### 47 U.S. Code § 1455

Upon receiving an application under subparagraph (A), an executive agency shall designate one or more appropriate individuals within the executive agency to act as a point of ...

[Get Price](#)

---

## FCC FACT SHEET Build America: Eliminating Barriers

**to ...**

ilities pursuant to sections 253 and 332(c)(7) of the Communications Act. We recognize that some state and local governments have taken important steps to modernize their approach to siting requests.13 ...

[Get Price](#)



### **eCFR :: 47 CFR Part 25 -**

Construction of such stations may commence prior to grant of an earth station license at the applicant's own risk, subject to the requirements of § 1.1312 and part 17 of this chapter concerning ...

[Get Price](#)

### **Wireless Facility Siting: Section 6409(a) Checklist**

Equipment associated with wireless communications services such as private, broadcast, and public safety services, as well as unlicensed wireless services and fixed wireless services such as ...

[Get Price](#)



### **Construction Requirements by Service**

Construct and place into operation at least 10% of designated geographic

areas within 2 years of initial license grant, 40% within 4 years, 70% within 6 years, and 100% of the designated geographic areas ...

[Get Price](#)



## Wireless Facility Siting: Section 6409(a) Checklist

Does not comply with conditions associated with the prior approval of the tower or base station unless non-compliance is due to an increase in height, increase in width, addition of cabinets, or new ...

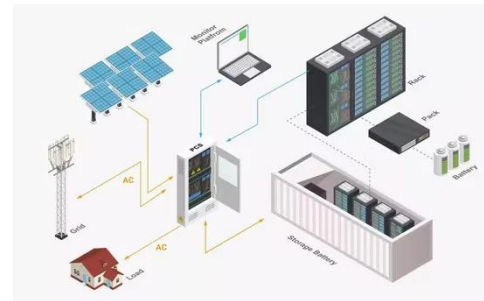

[Get Price](#)



## 2012 Spectrum Act, a.k.a. Section 6409(a)

These rules implement section 6409 of the Spectrum Act (codified at 47 U.S.C. 1455), which requires a State or local government to approve any eligible facilities request for a modification of an existing ...

[Get Price](#)

## 47 CFR § 24.103

(e) In demonstrating compliance with the construction requirements set forth in

this section, licensees must base their calculations on signal field strengths that ensure reliable service for the technology ...

[Get Price](#)

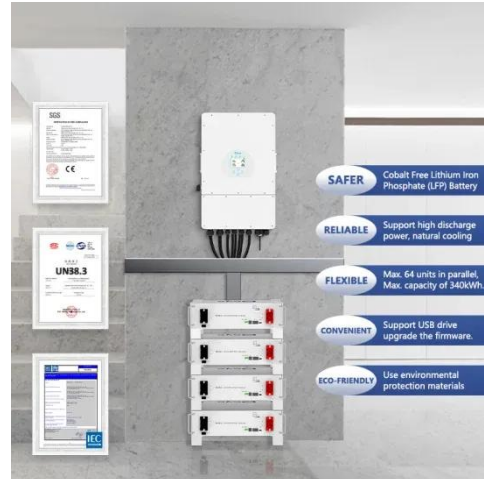

## Contact Us

---

For catalog requests, pricing, or partnerships, please visit:  
<https://www.cannabiswow.es>

